

RD110 ROBUST DETAILS CERTIFICATION SCHEME PLOT REGISTRATION APPLICATION FORM

For new build attached dwellings in England, Wales, Scotland and Northern Ireland. To be completed by the Developer and submitted before work starts on the dwellings.

MAIN CONTACT DETAILS (to whom all plot registration documents will be sent by email)

Name	Company
Address	
Postcode	Telephone No
Email	
Please indicate your role: Builder <input type="checkbox"/> Developer only <input type="checkbox"/> Designer <input type="checkbox"/> Other (please specify)	

BUILDER CONTACT DETAILS (details of the builder responsible for the construction of the robust details)

Builder Contact	Builder Company
Builder Address	
Postcode	

SITE DETAILS (details of the site where the robust details are to be constructed)

Site Name	
Site Address	
Postcode	

BUILDING CONTROL BODY (NAME)	NAME OF NEW HOME WARRANTY PROVIDER
IMPORTANT INFORMATION - MUST BE COMPLETED	

DEVELOPER OF THE SITE (the person named on the building control application)

Name	Company Name
Address	
Postcode	
Date	

By submitting this information, you confirm that you have read, understood and agree to the current version of Robust Details Limited's terms and conditions for plot registrations which can be found in the Support/Downloads area of our web site at www.robustdetails.com

HOW MANY PLOTS ON THIS APPLICATION WILL BE FOR SOCIAL HOUSING?	NAME OF SOCIAL HOUSING PROVIDER
<input type="text"/>	<input type="text"/>

PAYMENT Your Reference / P.O. No

Fee per Plot	No of Plots	Amount
£37.50		
Please accept payment by: (please tick box)		VAT@20%
Cheque <input type="checkbox"/> Card <input type="checkbox"/> BACS <input type="checkbox"/>		Total gross payment

BY CHEQUE:
Please make cheques payable to Robust Details Limited and attach them to this form.

BY CARD :
We will contact you by telephone using the telephone number from the MAIN CONTACT DETAILS section of this form to collect the card details.

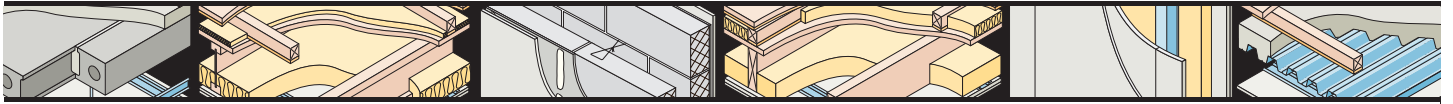

RD110 ROBUST DETAILS PLOT REGISTRATION

(New build only)

IMPORTANT: When selecting walls AND floors on Flats, refer to Table 3a, b or c of the Handbook to ensure compatibility.

Plots on BOTH sides of all Separating Elements must be included: i.e. in order to register the first separating floor in flats, Ground and 1st floor plots need to be entered.

Any separating walls or floors which are not registered with Robust Detail may be subject to the pre-completion testing (PCT) method of satisfying Requirement E1.

PLOT SCHEDULE (A photocopy of this page may be used as a continuation sheet if required)

EXAMPLE – one site with a block of flats and one row of terraced houses

Block No. / Name? if applicable e.g. A = Block A	Plot Number(s)? (e.g. 1-10 = Plots 1-10 etc.)	Quantity of Plots?	HOUSE? (H) joined house or bungalow or FLAT? (F) flat, apartment or maisonette	Wall RD Type? e.g. E-WM-11	Floor RD Type? For use in flats e.g. E-FC-1	
A	1 to 10	10	F	E-WM-11	E-FC-1	
N/A	21 - 24	4	H	E-WM-11	N/A	
Total			Carry forward to page 1 or if applicable, a continuation sheet			

Data Protection Act 2018 – Data Protection Notice. This notice only applies to an individual’s personal details. Robust Details Limited (RDL) is the data controller for the purposes of the Act. When you contact RDL your personal details will be recorded (or processed as the Act calls it). RDL will record your details for the purposes of dealing with your enquiries about robust details, the provision of services by RDL, administration, research and for statistical purposes. RDL may disclose your details to local and national authorities and Government Departments involved with robust details and the Building Regulations and to any warranty and insurance company providing cover on homes into which robust details are built for the purposes of its home registrations, inspections and claims handling. In the future, we may write or email you with information about our products and services. For more information please see our Privacy Policy available on our website.

If you do not wish to receive such information from us, please tick box